

## A SETTING UP YOUR TV STREAMER 2

The TV Streamer 2 supports both analog and digital audio input.

Depending on your TV, sound system, computer or other audio device, the installation of TV Streamer 2 may be done in several ways described on the following pages. Not all cables shown are included with the TV Streamer 2.

For **all** installations it is required that you:

1. Plug the power cord into the micro-USB socket on the TV Streamer 2
2. Plug the other end of the power cord into an electric wall outlet



Connect the TV Streamer 2 to your audio source using one of the following 5 installations.

### 1. CONNECTING THE TV STREAMER 2 TO A DIGITAL AUDIO SOURCE USING THE OPTICAL (TOSLINK) AUDIO INPUT

1. Insert one of the plugs on the optical audio cable into the optical audio input socket on the TV Streamer 2



**Note:** Most optical cables are delivered with a small protective cap to protect the tip of the cable. Please remove this protective cap before inserting the cable

2. Plug the other end of the optical audio cable into the "Digital Audio Out/Optical" on your audio source

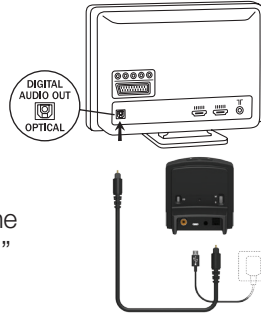

### 2. CONNECTING THE TV STREAMER 2 TO AN ANALOG AUDIO SOURCE (E.G. TV OR SOUND SYSTEM)

1. Plug the stereo mini-jack on the audio cable into the stereo mini-jack input on the TV Streamer 2
2. Plug the other end audio cord into the "AUDIO OUT" terminals on the audio source



The "AUDIO OUT" is usually marked "L - R" for left and right, and can usually be found on the back of the audio source.

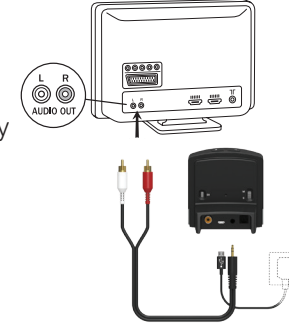

### 3. CONNECTING THE TV STREAMER 2 TO AN ANALOG AUDIO SOURCE USING A HEADPHONE MINI-JACK ADAPTOR

1. Plug the stereo mini-jack on the audio cable into the stereo mini-jack input on the TV Streamer 2



2. Connect the stereo mini-jack adapter to the red and white plugs at the other end of the audio cable

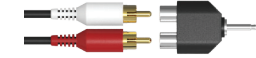

3. Plug the stereo mini-jack adapter into the audio sources' "HEADPHONE" output terminal

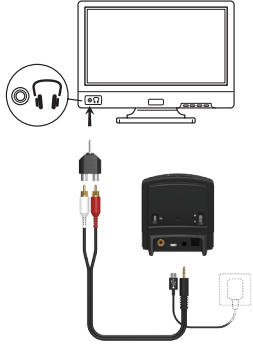

### 4. CONNECTING THE TV STREAMER 2 TO AN ANALOG AUDIO SOURCE USING A SCART ADAPTER

1. Plug the stereo mini-jack on the audio cable into the stereo mini-jack input on the TV Streamer 2
2. Connect the scart adapter to the red and white plugs at the other end of the audio cable

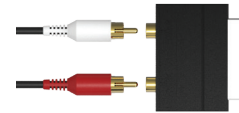

3. Plug the scart adapter into the audio source's scart terminal

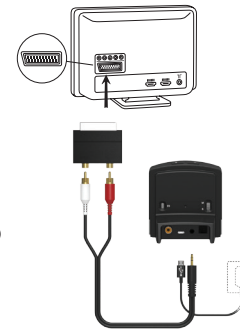

### 5. CONNECTING THE TV STREAMER 2 TO A DIGITAL AUDIO SOURCE USING THE COAXIAL AUDIO INPUT

1. Insert one of the plugs on the coaxial audio cable into the coaxial audio input socket on the TV Streamer 2



2. Plug the other end of the coaxial audio cable into the "Digital Audio Out/Coaxial" on your audio source

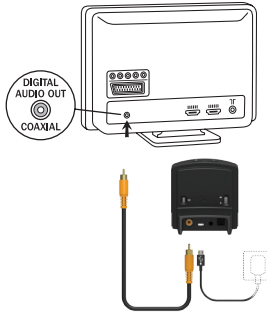

400249244-US-13.12-Rev/B

**Resound North America**  
8001 Bloomington Freeway  
Bloomington, MN 55420  
phone: 1-888-735-4327

**Resound Canada**  
303 Superstest Road  
Toronto, Ontario M3J 2M4  
phone: 1-888-737-6863

## B PAIRING TO YOUR HEARING INSTRUMENTS

**Note:** Check with your hearing healthcare professional to determine if your hearing instruments have been pre-paired. Instruments that have been pre-paired do not need to be paired again.

1. Make sure the TV Streamer 2 is plugged into a wall socket and that the green power light is on



2. Open the battery doors on both hearing instruments

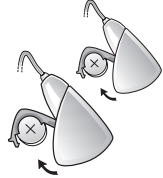

3. Press the pairing button on the TV Streamer 2 once to activate the pairing mode



4. You can tell that the pairing mode has been activate when channel indicator is flashing. Pairing mode will be active for 20 seconds



5. While the channel indicator light is flashing, close the battery doors on both hearing instruments.

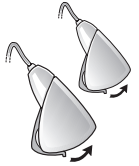

**Note:** Successful pairing will be indicated by an audible melody played in both hearing instruments. You are now ready to use the TV Streamer 2!

## C LISTENING TO YOUR TV STREAMER 2

After setting up and pairing, you can listen to streamed audio from the TV Streamer 2 as follows.

With your TV, sound system or computer turned on ...

EITHER: Press and hold the push button on your hearing instruments for 3 seconds.

This must be done separately on both hearing instruments, in order to hear streamed audio in both ears, unless your hearing instruments have been set up with device-to-device synchronisation;

OR: If you have a Remote Control (optional), simply press the streaming button on this Remote Control.



Once TV Streamer 2 has been connected, an audible melody will play in your hearing instruments and will be followed by the streamed audio.

When using the optional Remote Control, the display will show that it is searching, and then indicate that it is connected to the TV Streamer 2.

## PAIRING TO A SECOND OR THIRD TV STREAMER 2

It is possible to pair up to three TV Streamer 2 units with a given pair of hearing instruments.

To pair a second or third TV Streamer 2:

Follow steps 1 and 2 under **B**

- Then press the pairing button of the second ReSound Unite TV 2 TWO or THREE times
- The yellow light indicator on the front of the TV Streamer 2 will now blink twice or three times every 2 seconds to indicate that it is ready to be paired in channel 2 or 3
- Complete the pairing process by closing the battery doors on the hearing instruments

Pairing button pushes	Light indicator pattern	Channel
1	1 1 1 1	1
2	1 2 1 2 1 2 1 2	2
3	1 2 3 1 2 3 1 2 3 1 2 3	3

## TO STOP LISTENING TO STREAMED AUDIO

EITHER: Shortly press and release the push button on your hearing instrument;

OR: Press the "P" button on the remote control

### TIPS AND SUPPORT

For more details on the TV Streamer 2, refer to the user guide.